

# Versatile™ 4C Mailbox, 4C15S-04

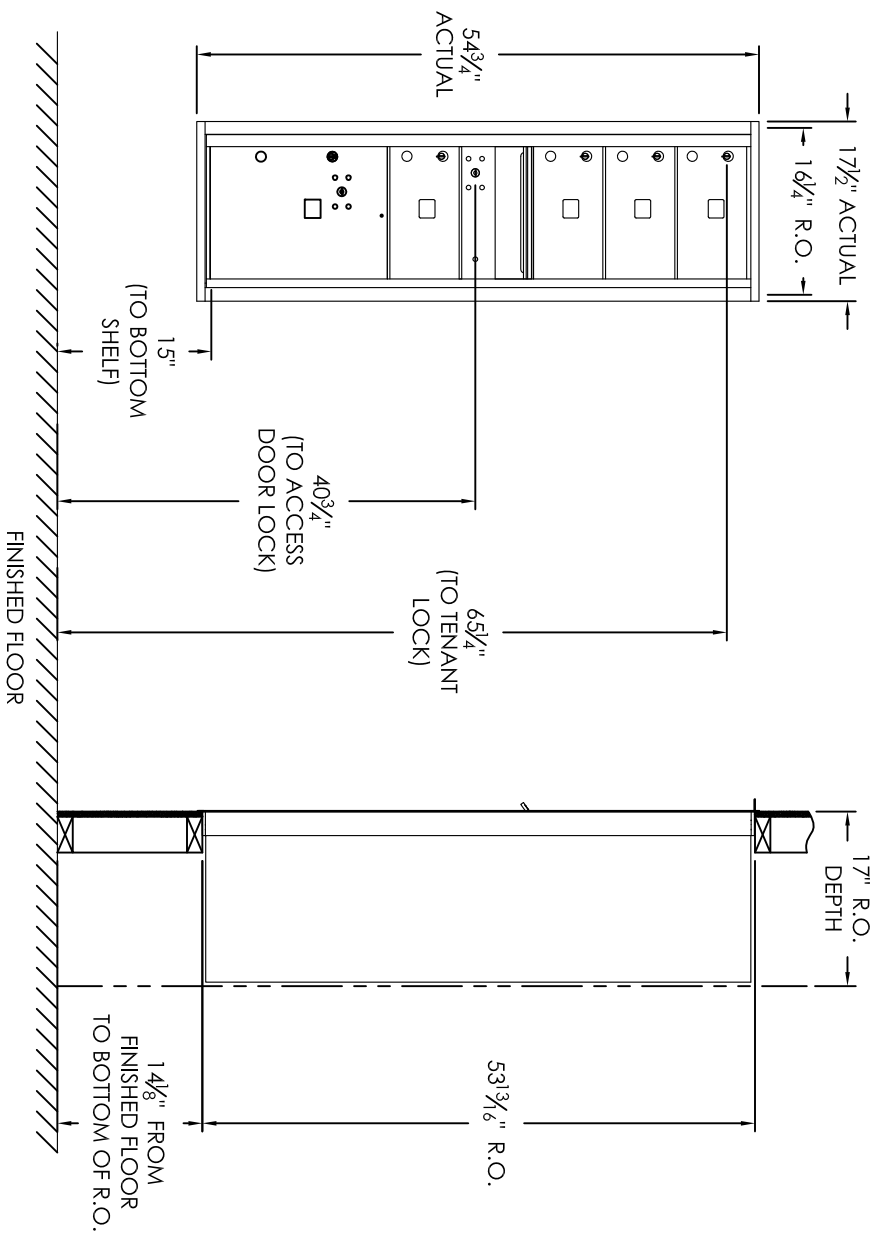

COMPARTMENT CHART

DESCRIPTION	COMPARTMENT	COMPARTMENT SIZE	QTY.
MAILBOX	MB2	6-1/2" H x 12" W x 15" D	4
OUTGOING MAIL	OM2	6-1/2" H x 12" W x 15" D	1
PARCEL	PL5	17" H x 12" W x 15" D	1

PRODUCT SERIES: VERSATILE™ 4C FRONT LOAD MAILBOX

**AF FLORENCE**  
**manufacturing company**

5935 Corporate Drive • Manhattan, KS 66503  
 www.florencemailboxes.com • (800) 275-1747

A GIBRALTAR INDUSTRIES COMPANY

MODEL: 4C15S-04 REV: D

SCALE: NONE LAST REV DATE: 5/16/14

DRAWING NUMBER: 4C15S-04CS DRAWN BY: RS

**Notes:**

1. This module meets the USPS STD-4C requirements for installation defined below when the mailbox is installed per the dimensions provided on this drawing.

- a. At least one customer compartment shall be positioned less than 48" above finished floor (AFF).
  - b. No parcel locker (interior bottom shelf) shall be positioned less than 15" AFF.
  - c. No patron (tenant) lock shall be positioned more than 67" AFF.
  - d. No customer compartment (interior bottom shelf) shall be positioned less than 28" AFF.
  - e. The USPS Arrow lock shall be positioned 36"-48" AFF.
2. This 4C mailbox can also be used for private applications.
3. The rough opening width for multi-unit 4C installations = (the sum of all actual unit widths) - 1/8".